

1012 / 1013

- ▶ Cover frame and lid have mirror finish. Lift-up, insulating lid with inner camber, no dripping back of condensate into the tubes.
- ▶ Corrosion-resistant outer housing, made of electrolytically galvanised sheet steel, powder-coated. Drain cock at the back.

Applications

All Water Baths models 1002 to 1013 are successfully used for incubations and inactivations of cultures, such as e.g. for warming bacteriological media, carrying out chemical reactions or thawing samples.

The circulation system of Water Baths 1012 and 1013 ensures optimum temperature uniformity throughout the whole bath. An electric motor with rotary magnet is flanged to the bath floor. Its torque is transmitted to a PTFE coated stirring magnet in the bath. The stirring magnet forces the water into the centre of the bath and then evenly back again.

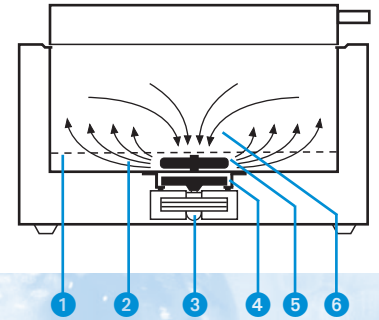

- 1 Perforated floor
- 2 Water circulation
- 3 Motor
- 4 Rotary magnet
- 5 Stirring magnet
- 6 Water circulation



1013 Water Bath with circulation system, 14 litres

Additional technical data of models 1002 - 1013

Temperature regulation:	Microprocessor-controlled
Temperature constancy:	±0.1 °C temporal at 50 °C
Temperature range:	approx. 5 °C above ambient temperature to +99.9 °C
with water level regulator 1919:	approx. 3 °C above tap water temperature to +99.9 °C
Over-temperature cut-out:	electronic, 4 °C above set temperature and electro-mechanical >130 °C

Technical data

Model Order No.	Interior dimensions			Exterior dimensions			Capacity approx. litres	Electrical connection*	Weight approx.		Packing volume approx m ³
	Width mm	Depth mm	Working height [◆] mm	Width mm	Depth mm	Height mm			net kg	gross kg	
1012	245	200	145	340	395	325	7	230 V / 50...60 Hz / 1.0 kW	10,6	12	0.11
1013	400	245	145	500	440	325	14	230 V / 50...60 Hz / 1.5 kW	14,6	17	0.13

◆ perforated floor to upper rim

* Other voltages available on request